

Product description

The WEMS Digital Input module provides four optically isolated inputs for status and alarm monitoring or meter pulse counting. Maximum pulse count frequency is 10Hz. LEDs provide status indication for each channel. Inputs require (wetting) voltage of 12–48VDC.

Features

- Pluggable, snap-fit modular system
- Can be used with 3rd party BMS using WEMS BACnet Gateway
- DIN rail mount
- Status LEDs
- 4 × digital inputs, configurable for status, alarm or pulse



Specification

Temperature & humidity

Operating Temperature Range -10 to +50 °C
Operating Humidity < 75% RH (Non condensating)
Storage Temperature -20 to +85 °C
Storage Humidity < 90% RH (Non condensating)
Cooling Convection

Power

Supply Voltage Modular BUS powered
Power 0.400W max

Inputs

Digital Inputs 4 × Opto isolated 48Vdc digital inputs

Misc

Enclosure UL94-VO flame retardant PC, IP20 rated
Mounting 35mm DIN rail (EN 50022, BS 5584, DIN 46277-3)
MTBF 1,812,792 hours

Compliance

EMC
 EN 301 489 Electromagnet compatibility
 EN 61000 Electromagnet compatibility

Safety

EN 60950 Information technology equipment
 EN 60730 Automatic electrical controls
 EN 50366 Domestic equipment

Certifications

CE, RoHS, UL

Dimensions & weight

Weight 67g with connector
Height 110mm
Width 25mm
Depth 58mm

Diagram

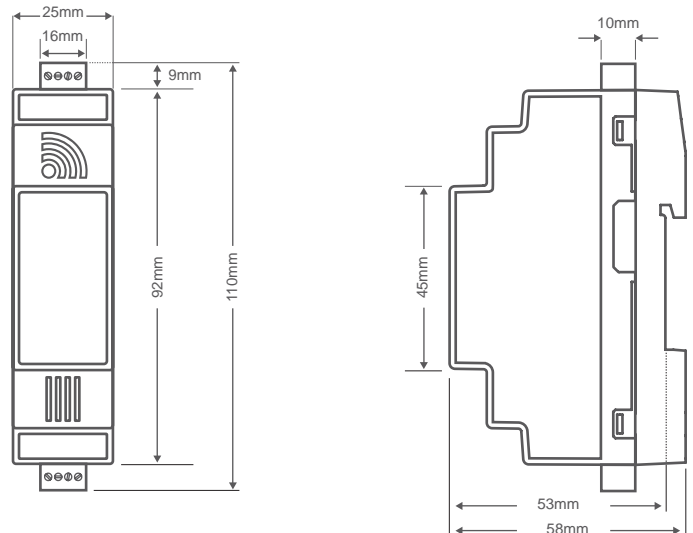

Terminal contacts

